

MagDrill Disruptor 43 | P/N: 81001240

Summary

By combining Magswitch’s patent-pending rotating magnet technology and Cayken’s new light weight yet powerful drill, we have created a tool that is capable of quickly and safely drilling on curved and flat surfaces. Magswitch LAY magnet arrays improve field efficiency on thin material, allowing more consistent tip forces up to full saturation.

Specifications

Maximum Magnetic Force ^{1,2}	1172 lbs / 532 kg
Magnet Assembly (L x W x H)	187mm x 165mm x 83mm 7.36" x 6.49" x 3.27"
Full Saturation Thickness	0.5" / 12.7mm
Maximum Tip Force ^{1,2,3}	609 lbs / 276 kg
Smallest Pipe Diameter	3.5" / 90mm
Rated Input Power	1700 W
Speed (No Load)	100-730 RPM
Rated Voltage	110/220 V AC
Rated Frequency	50/60 Hz
Drill Stroke	5.1" / 130mm
Cutting Depth	1 11/16" / 43 mm
Maximum Cutter Diameter	Ø 1 11/16" / Ø 43 mm
Cable Length	8.2' / 2.5m
Overall Height (Max)	21" / 533.4mm
Overall Length	11" / 279.4mm
Overall Width	10" / 254.0mm
Net Weight	26.2 lbs / 11.9 kg

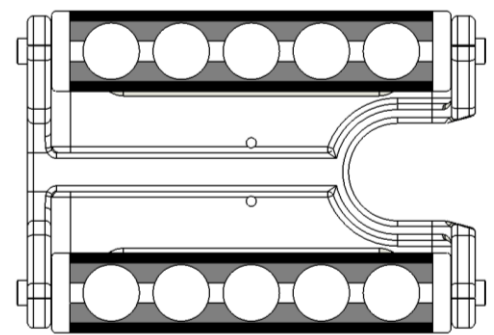

WORKING SURFACE
BLACK=BEST **GRAY=MODERATE**

WARNING!
Do Not Operate Unless In
Contact With Ferrous Target

¹ Determined in laboratory environment on 2" thick SAE1018 Steel with surface roughness 63 micro inches with optimized pole shoes. Many factors contribute to the actual breakaway force and safe working load in each application. Consult a Magswitch Applications Engineer and test the Magswitch in each application before deployment.

² Values may vary by +/- 5%.

³ Tip Force measured on flat surface